

CITY OF RAHWAY

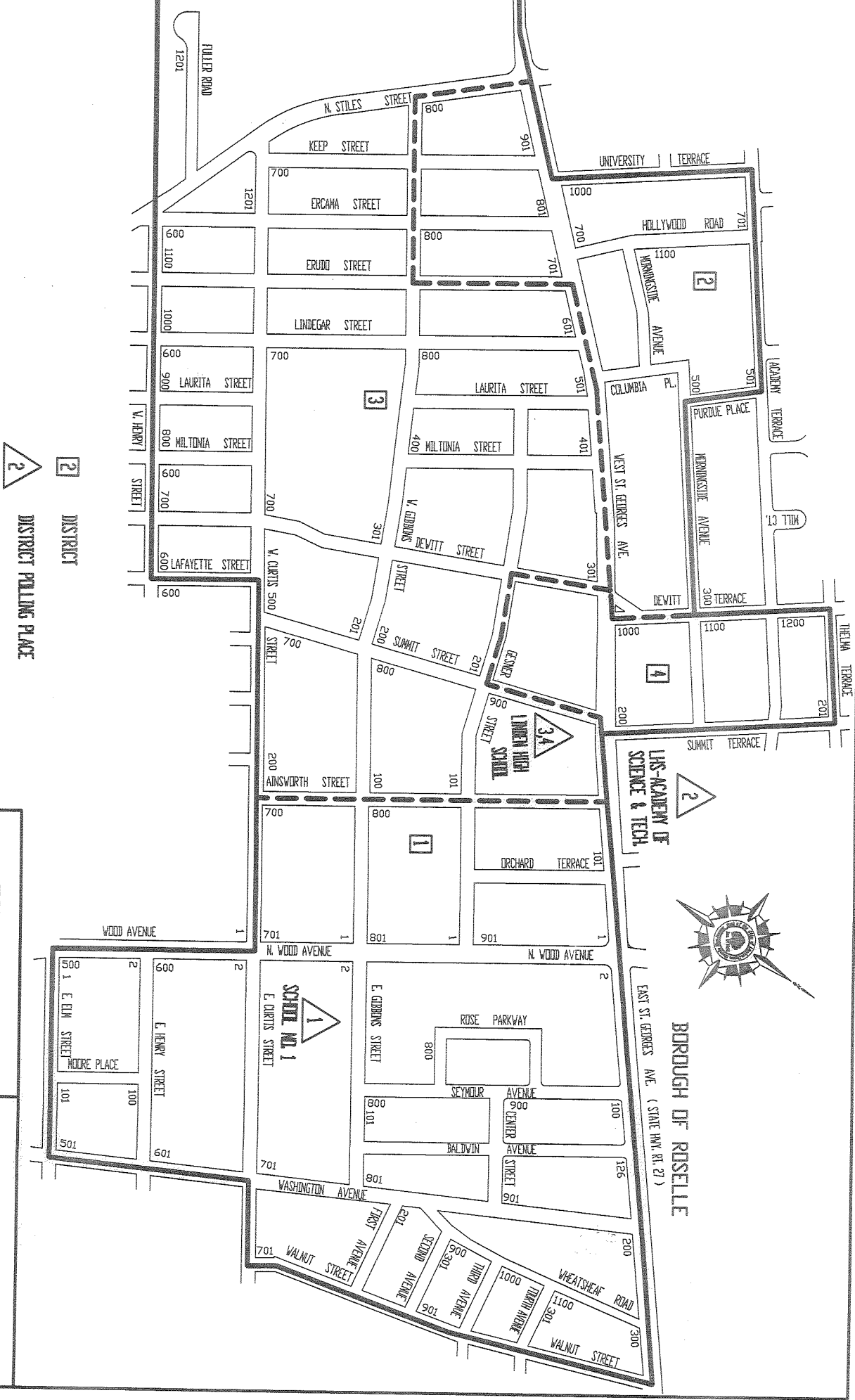

[2] DISTRICT
 [2] DISTRICT POLLING PLACE
 [3] DISTRICT
 [4] DISTRICT

FIRST WARD

CITY OF RAHWAY
 ENGINEERING DEPARTMENT
 301 WOOD AVE. - 2ND FLOOR
 LINDEN UNION COUNTY, N.J. 07036

DESIGNED BY	SCALE	DATE
GEORGE R. VIRCIK	AS SHOWN	3-10-09
CHECKED BY	DATE	
GEORGE R. VIRCIK		
DATE		
3-10-09		

GEORGE R. VIRCIK
 PROFESSIONAL ENGINEER, N.J. LIC. No. 21889
George R. Vircik
 DATE: 3-10-09

BOROUGH OF ROSELLE

